

**RKCN**

Konfektionierbarer Steckverbinder, M12-Kupplung mit Sechskant-Edelstahlverschraubung, Konfektionierung über Schraubklemmen  
 – besonders für den Einsatz in Nahrungsmittelmaschinen geeignet –

Field attachable connector, M12 female connector with stainless steel hexagon threaded joint, assembling with screw terminals  
 – especially designed for use in food processing equipment –

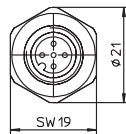
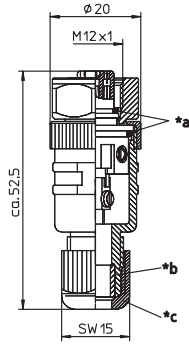

- \*a O-Ring  
O-ring
- \*b Dichtung  
gasket
- \*c Hutmutter  
cap nut

**RKCWN**

Konfektionierbarer Steckverbinder, M12-Winkelkupplung mit Sechskant-Edelstahlverschraubung, Konfektionierung über Schraubklemmen  
 – besonders für den Einsatz in Nahrungsmittelmaschinen geeignet –

Field attachable connector, M12 female right angle connector with stainless steel hexagon threaded joint, assembling with screw terminals  
 – especially designed for use in food processing equipment –

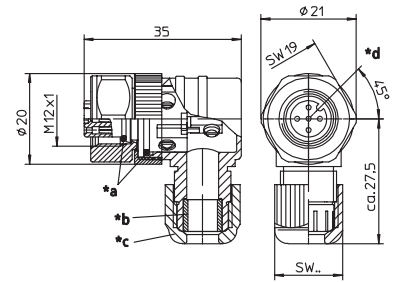

- \*a O-Ring  
O-ring
- \*b Dichtung  
gasket
- \*c Hutmutter  
cap nut
- \*d Einsatz um 90° drehbar  
insert 90° rotatable

**Pinbelegung  
Pin assignment**

**4-polig  
4 poles**















**5-polig  
5 poles**



**8-polig  
8 poles**



<b>Technische Daten</b>		<b>Technical data</b>	
<b>Umgebungstemperatur</b>	-25°C / +90°C 8-polig -25°C / +85°C	<b>Operating temperature range</b>	-25°C / +90°C 8 poles -25°C / +85°C
<b>Werkstoffe</b>		<b>Materials</b>	
Gehäuse / Griffkörper	PBT	Housing / Molded body	PBT
Kontaktträger	PBT	Insert	PBT
Kontakt	CuZn, unterkupfert, CuSnZn 8-polig unternickelt, vergoldet	Contact	CuZn, pre-coppered, CuSnZn 8-poles pre-nickel, gold-plated
Gewindebuchse / Rändel- schraube/-mutter / Sechskant- schraube/-mutter / Hülse	Edelstahl	Receptacle shell / knurled screw/ nut / hexagon screw/nut / sleeve	stainless steel
O-Ring	FKM	O-ring	FKM
<b>Mechanische Daten</b>		<b>Mechanical data</b>	
Schutzart	IP 67 Nur im verschraubten Zustand mit den dazugehörigen Gegen- stücken.	Degree of protection	IP 67 Only in locked position with its proper counterparts.
Anschlussart	Schraubanschluss	Mode of connection	screw terminals
Anschließbarer Leiter	4- bis 5-polig max. 0,75 mm <sup>2</sup> 8-polig max. 0,50 mm <sup>2</sup>	Connectable conductor	4–5 poles max. 0.75 mm <sup>2</sup> 8 poles max. 0.50 mm <sup>2</sup>
<b>Elektrische Daten</b>		<b>Electrical data</b>	
Durchgangswiderstand	≤ 5 mΩ	Contact resistance	≤ 5 mΩ
Nennstrom bei 40°C	4- bis 5-polig 4 A 8-polig 2 A	Nominal current at 40°C	4–5 poles 4 A 8 poles 2 A
Nennspannung	4-polig 240 V 5-polig 60 V 8-polig 30 V	Nominal voltage	4 poles 240 V 5 poles 60 V 8 poles 30 V
Bemessungsspannung	4-polig 250 V 5-polig 63 V 8-polig 36 V	Rated voltage	4 poles 250 V 5 poles 63 V 8 poles 36 V
Prüfspannung	4-polig 2,0 kV eff. / 60 s 5-polig 1,5 kV eff. / 60 s 8-polig 0,9 kV eff. / 60 s	Test voltage	4 poles 2.0 kV eff. / 60 s 5 poles 1.5 kV eff. / 60 s 8 poles 0.9 kV eff. / 60 s
Isolationswiderstand	> 10 <sup>9</sup> Ω	Insulation resistance	> 10 <sup>9</sup> Ω
Verschmutzungsgrad	3	Pollution degree	3

Bestellbezeichnung Designation		Polzahl Poles	Kabelverschraubung Screw joint for cable	
RKCN 4/7	RKCWN 4/7	4	Ø 3,0–6,5 mm /SW 15	  
RKCN 4/9	RKCWN 4/9		Ø 4,0–8,0 mm /SW 19	  
RKCN 5/7	RKCWN 5/7	5	Ø 3,0–6,5 mm /SW 15	  
RKCN 5/9	RKCWN 5/9		Ø 4,0–8,0 mm /SW 19	  
RKCN 8/9			Ø 4,0–8,0 mm /SW 19	