

## HD D-Sub Steckverbinder, gewinkelt, Lötstifte HD D-Sub Connectors, Right-Angled, Solder Pins

### Technische Daten / Technical Data

Gehäuse	Stahl vernickelt, verzinkt
Shell	Steel, tin coated over nickel
Isolierkörper	Thermoplast, nach UL94 V-0
Insulator	Thermoplastic, rated UL94 V-0
Kontaktmaterial	Kupferlegierung
Contact Material	Copper alloy
Kontaktoberfläche	Gold über Nickel
Contact Surface	Gold over nickel
Durchgangswiderstand	< 20 mΩ
Contact Resistance	< 20 mΩ
Isolationswiderstand	> 500 MΩ
Insulation Resistance	> 500 MΩ
Spannungsfestigkeit	500 V AC
Test Voltage	500 V AC
Nennstrom	3 A
Current Rating	3 A
Temperaturbereich	-55 °C ... +125 °C
Temperature Range	-55 °C ... +125 °C
Verarbeitung	Wellenlötverfahren
Processing	Wave soldering
Güteklasse	GK 3, min. 50 Steckzyklen, andere GK auf Anfrage
Quality Class	Quality class 3, min. 50 cycles, more quality options on request

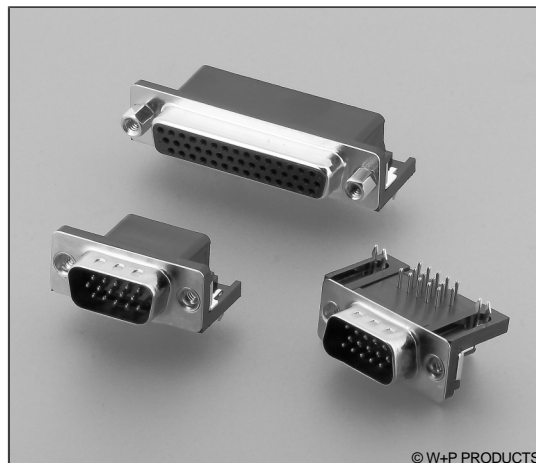

© W+P PRODUCTS

PCB-Layouts s. Tech. Info.  
PCB Layouts in Tech. Info.

Stift / Male

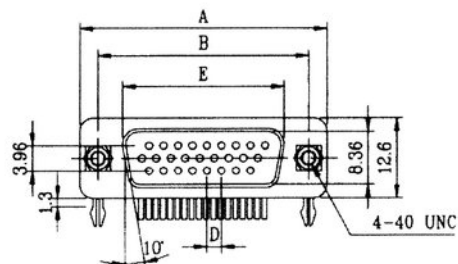

Buchse / Female

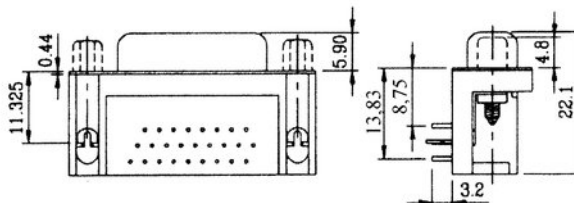
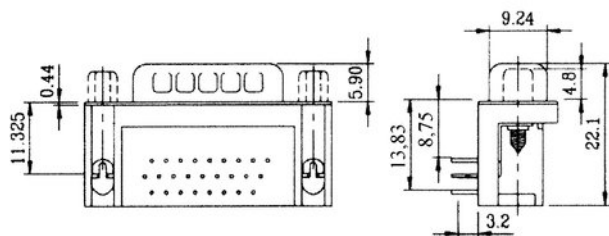
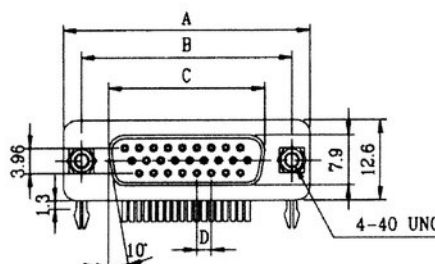

n	A	B	C	D	E
15	30,80	24,99	16,33	2,29	17,70
26	39,10	33,32	24,66	2,29	26,00
44	53,00	47,04	37,66	2,29	40,20
62	69,30	63,50	54,83	2,41	56,70

Series

**110**

Contacts\*

**44**  
15/26/44/62

Terminal\*

**1**  
1 Stift  
Male  
2 Buchse  
Female

Dimensions\*

**1**  
1 Masseblech vernietet, Gewindeniet UNC 4-40  
Riveted grounding brackets, UNC 4-40 rivet  
2 Masseblech mit UNC 4-40 Gewinde  
mit befestigten Bolzen (nur Bolts-Option 20),  
Economy-Version  
Grounding brackets with UNC 4-40 thread  
with assembled bolts (only Bolts-option 20),  
economy version

Bolts\*

**00**  
00 Ohne Bolzen  
W/o bolts  
10 Bolzen lose  
Loose bolts  
20 Bolzen montiert  
Assembled bolts

\* Dies ist ein **Bestellbeispiel** -  
bitte durch Ihre Spezifikationen ersetzen.  
\* This is an **order example** -  
please replace by your specifications.

# Leiterplatten-Layouts für HD D-Sub-Verbinder

## PCB Layouts for HD D-Sub Connectors

### Gerade Ausführung / Straight Type

Stift / Male

Buchse / Female

15-pol.

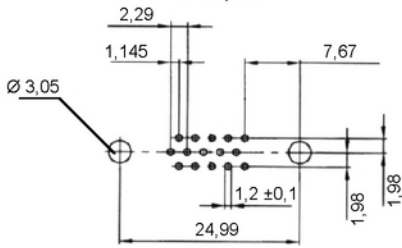

15-pol.

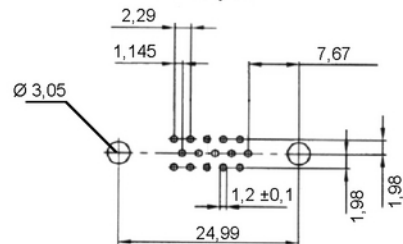

26-pol.

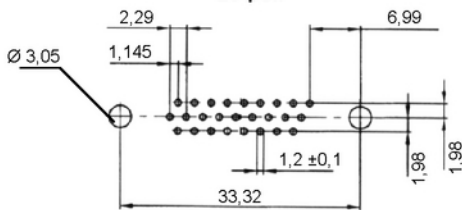

26-pol.

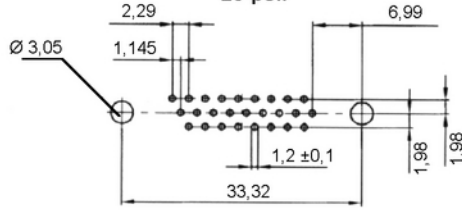

44-pol.

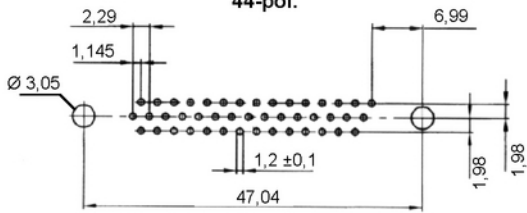

44-pol.

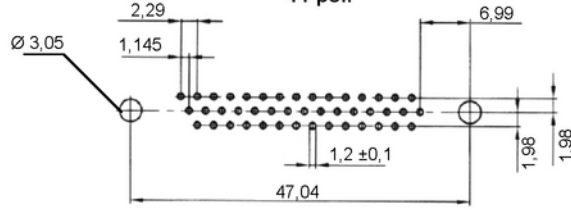

62-pol.

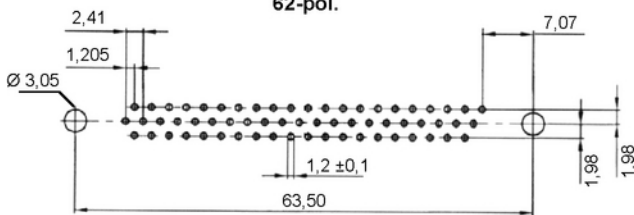

62-pol.

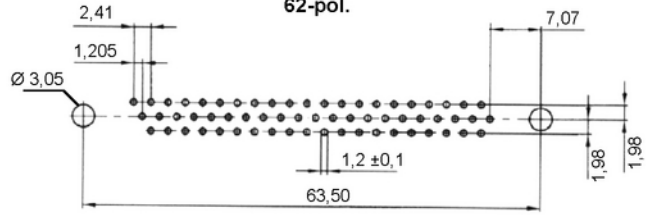

78-pol.

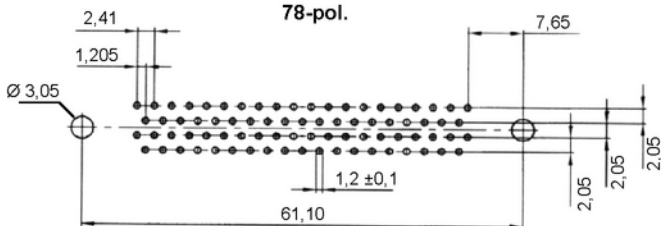

78-pol.

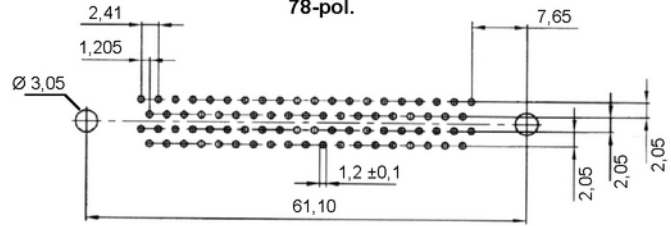

Gewinkelte Ausführung / Right-angled Type

Stift / Male

Buchse / Female

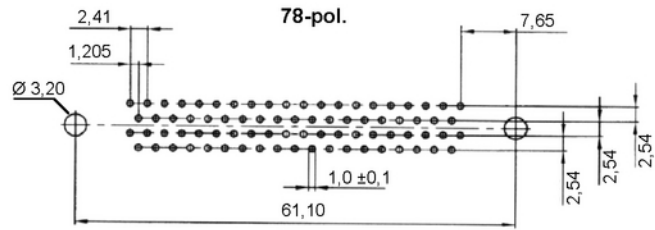
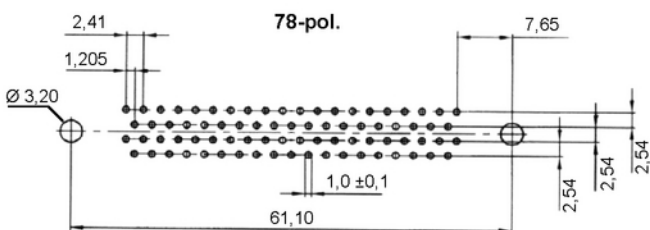
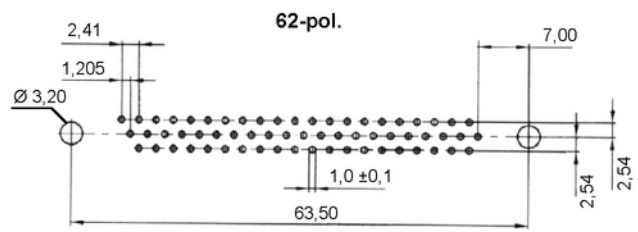
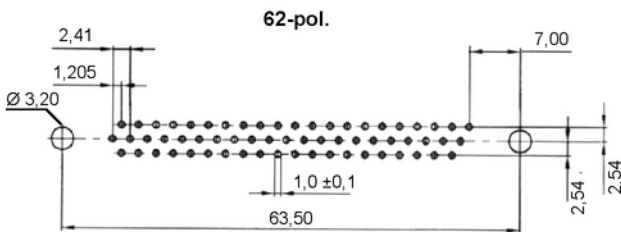
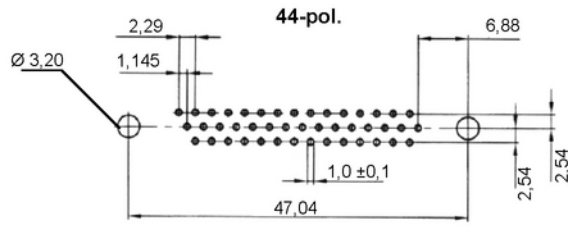
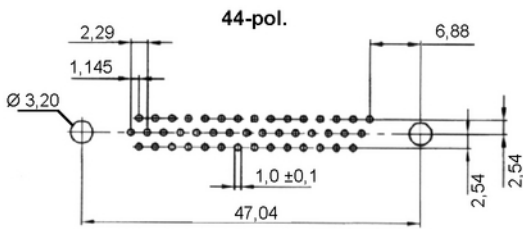
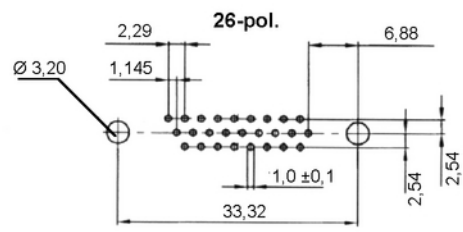
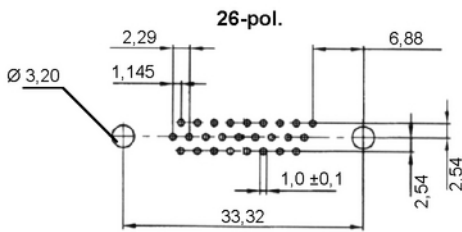
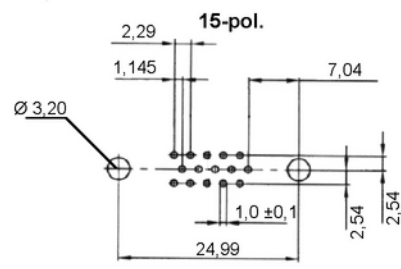
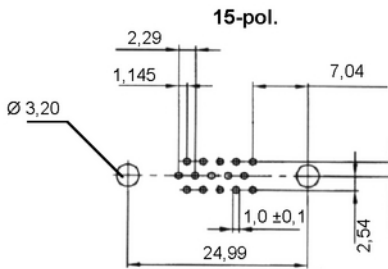

### Empfehlungen für das Wellenlötverfahren

#### Recommendations for Wave Soldering

Die Bauteile sollten bei einer Lötbadtemperatur von 260°C in max. 5 Sekunden verlötet werden.  
*Items should be soldered at a solder temperature of 260°C in 5 seconds max.*

Empfohlenes Wellenlötprofil:  
*Recommended wave soldering profile:*

