

HD D-Sub Steckverbinder, gerade, Lötstifte HD D-Sub Connectors, Straight, Solder Pins

Technische Daten / Technical Data

Gehäuse	Stahl vernickelt, verzinkt
Shell	Steel, tin coated over nickel
Isolierkörper	Thermoplast, nach UL94 V-0
Insulator	Thermoplastic, rated UL94 V-0
Kontaktmaterial	Kupferlegierung
Contact Material	Copper alloy
Kontaktoberfläche	Gold über Nickel
Contact Surface	Gold over nickel
Durchgangswiderstand	< 20 mΩ
Contact Resistance	< 20 mΩ
Isolationswiderstand	> 500 MΩ
Insulation Resistance	> 500 MΩ
Spannungsfestigkeit	500 V AC
Test Voltage	500 V AC
Nennstrom	3 A
Current Rating	3 A
Temperaturbereich	-55 °C ... +125 °C
Temperature Range	-55 °C ... +125 °C
Verarbeitung	Wellenlötverfahren
Processing	Wave soldering

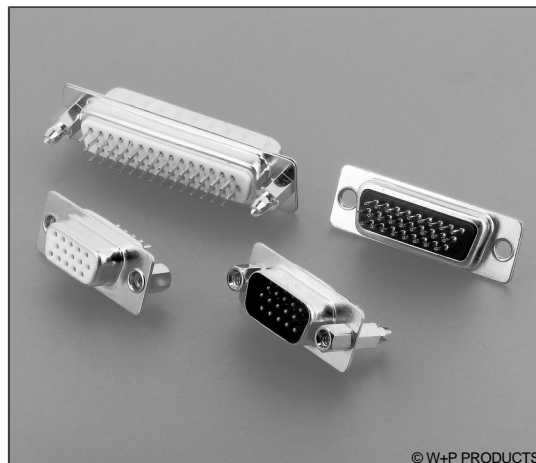

© W+P PRODUCTS

PCB-Layouts s. tech. Info.
PCB Layouts in Tech. Info.

Stift / Male

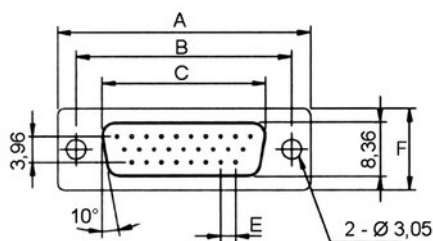

Buchse / Female

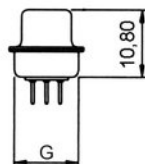
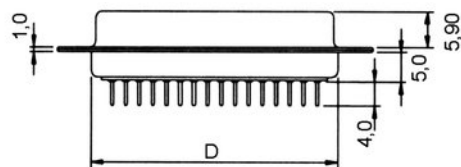
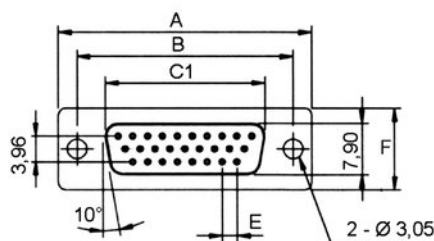

n	A	B	C	C1	D	E	F	G
15	30,80	24,99	16,92	16,33	19,30	2,29	12,55	10,72
26	39,10	33,32	25,25	24,66	27,50	2,29	12,55	10,72
44	53,00	47,04	38,25	37,66	41,03	2,29	12,55	10,72
62	69,30	63,50	55,42	54,84	57,70	2,41	12,55	10,72
78	66,90	61,11	52,86	52,34	55,30	2,41	15,40	13,60

Series **109** — Contacts* **15** (15/26/44/62/78) — Terminal* **2** (1 Stift Male, 2 Buchse Female) — Quality **3** (GK 3 >50 Steckzyklen, andere GK auf Anfrage, Min. 50 cycles, other quality classes by request) — Mounting* **0** (0 ... CL Lt. Tech. Info. See Tech. Info.)

* Dies ist ein **Bestellbeispiel** - bitte durch Ihre Spezifikationen ersetzen.
* This is an **order example** - please replace by your specifications.

Leiterplatten-Layouts für HD D-Sub-Verbinder

PCB Layouts for HD D-Sub Connectors

Gerade Ausführung / Straight Type

Stift / Male

Buchse / Female

15-pol.

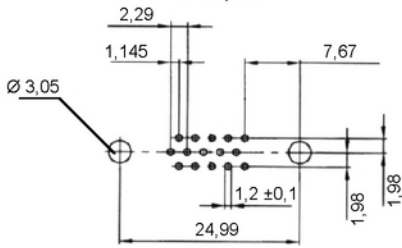

15-pol.

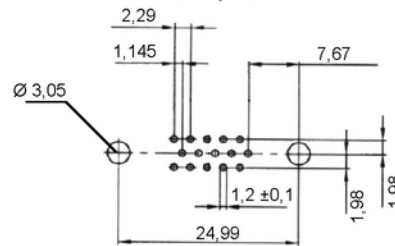

26-pol.

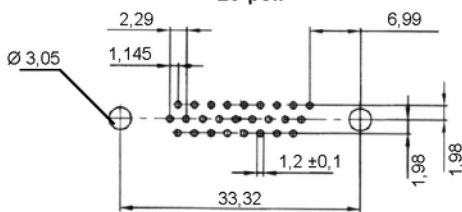

26-pol.

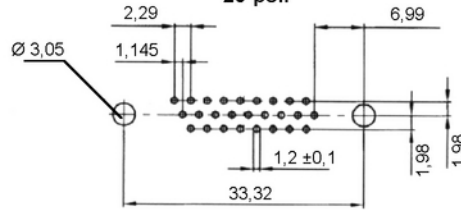

44-pol.

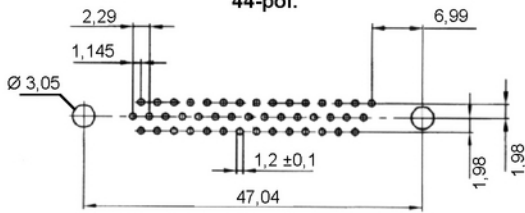

44-pol.

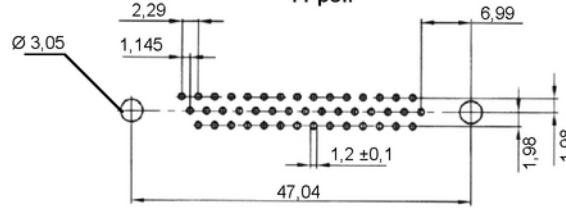

62-pol.

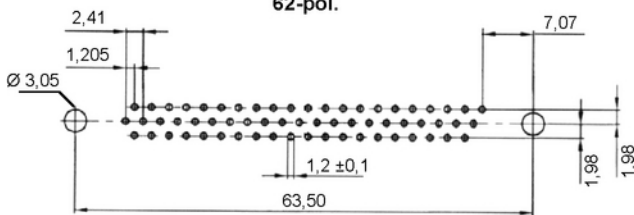

62-pol.

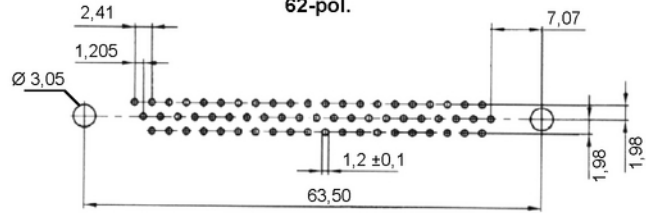

78-pol.

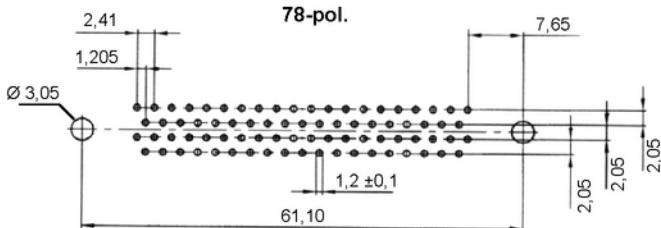

78-pol.

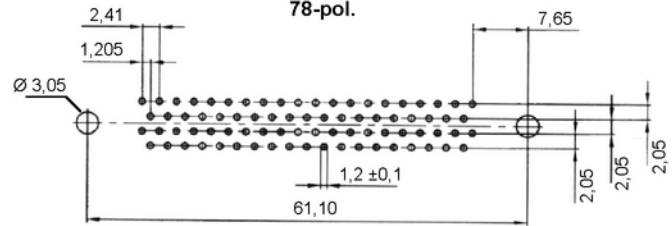

Gewinkelte Ausführung / Right-angled Type

Stift / Male

Buchse / Female

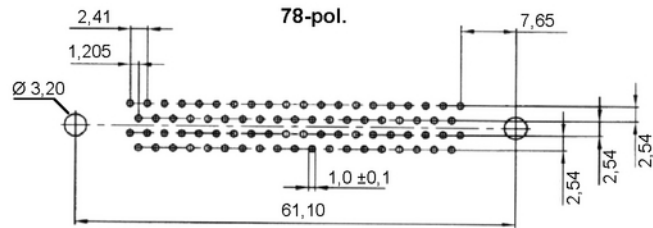
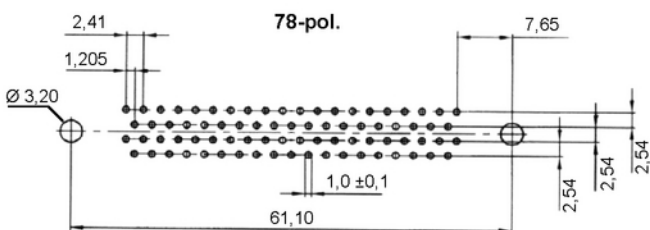
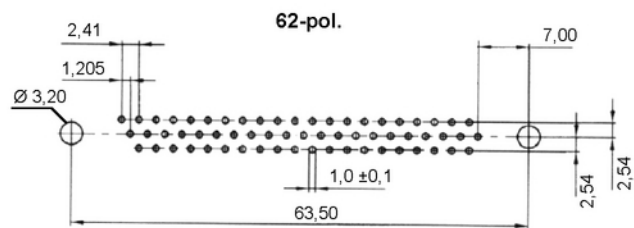
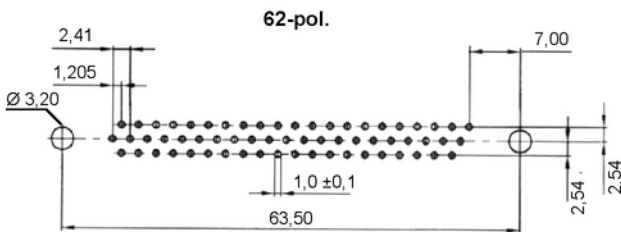
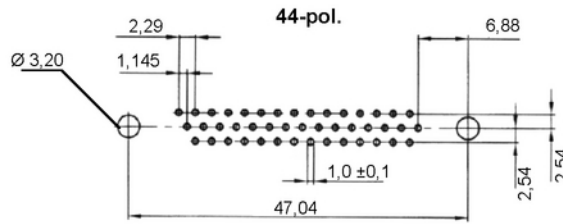
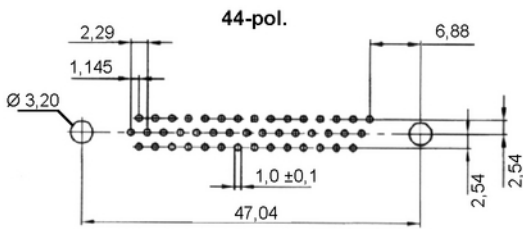
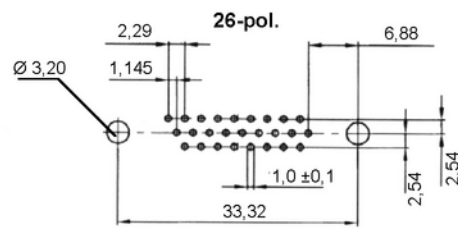
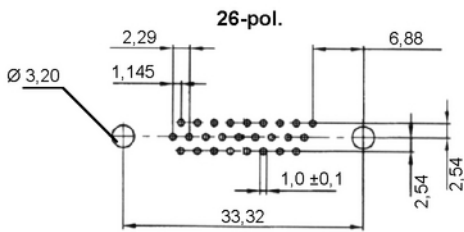
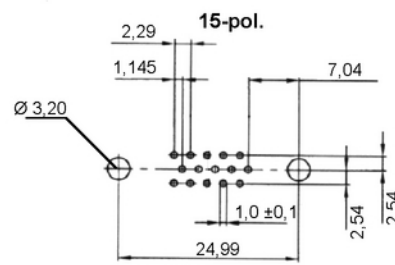
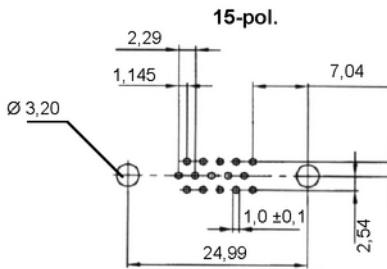

Durchgangsloch / Through Hole

0 Durchgangsloch 3,05mm
3.05mm Through Hole

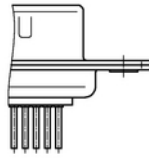

Gewindeniet vorn / Thread Rivet Front

B1 Gewindeniet UNC 4-40
UNC 4-40 Thread Rivet
B2 Gewindeniet M3
M3 Thread Rivet

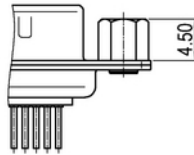

Gewindeniet hinten / Thread Rivet Back

1 Gewindeniet UNC 4-40
UNC 4-40 Thread Rivet
2 Gewindeniet M3
M3 Thread Rivet

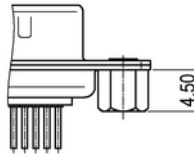

Gewindebolzen vorn / Thread Bolt Front

3 Gewindebolzen UNC 4-40
UNC 4-40 Thread Bolt
4 Gewindebolzen M3
M3 Thread Bolt

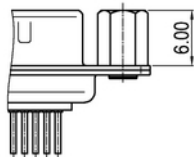

Gewindebolzen hinten / Thread Bolt Back

5 Gewindebolzen UNC 4-40
UNC 4-40 Thread Bolt
6 Gewindebolzen M3
M3 Thread Bolt

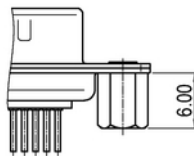

Board Lock

BL Board Lock mit UNC 4-40 Gewinde
Board Lock with UNC 4-40 Thread

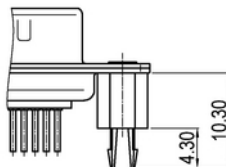

Combi-Lock

CL Combi-Lock mit UNC 4-40 Gewinde
Combi Lock with UNC 4-40 Thread

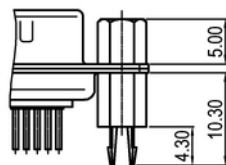

Empfehlungen für das Wellenlötverfahren

Recommendations for Wave Soldering

Die Bauteile sollten bei einer Lötbadtemperatur von 260°C in max. 5 Sekunden verlötet werden.
Items should be soldered at a solder temperature of 260°C in 5 seconds max.

Empfohlenes Wellenlötprofil:
Recommended wave soldering profile:

